

13 12 11 10 9 8 7 6 5 4 3 2 1

MATERIALS AND FINISHES

BODY BRASS
PLATED GOLD

CENTER CONTACT BERYLLIUM COPPER
PLATED GOLD

INSULATOR TEFLON

PACKAGING: SEE TABLE

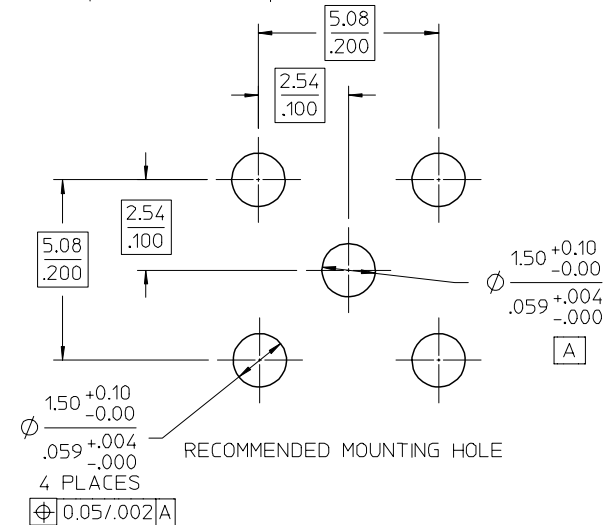
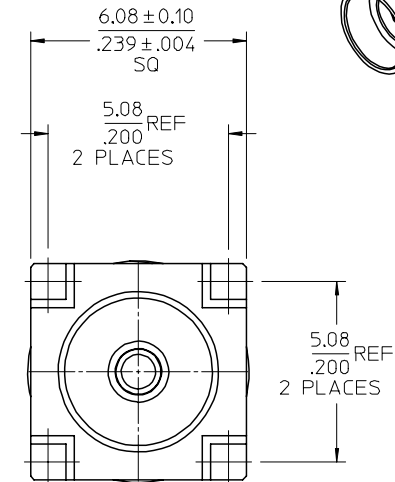
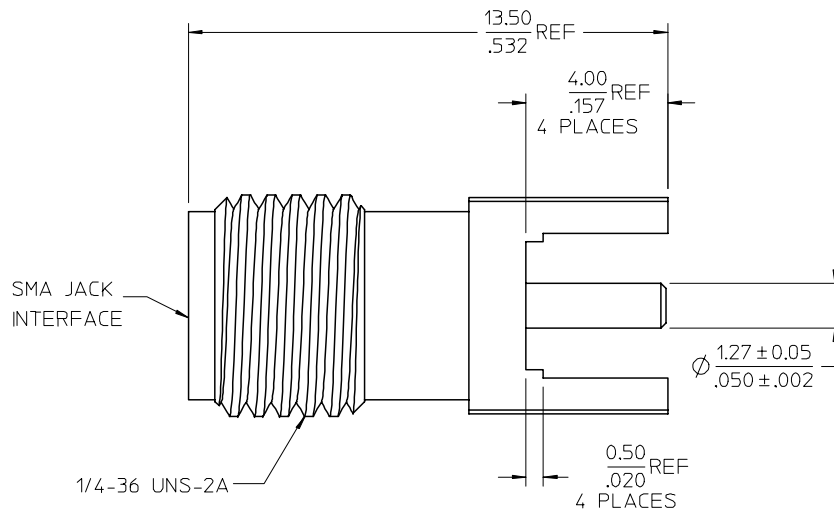
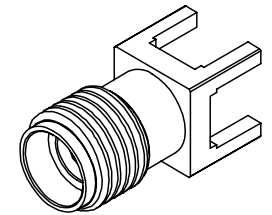

73391-0072	73391-0070 BY TRAY (20 CAV.)
73391-0071	73391-0070, ONE PER BAG
73391-0070	TRAY (80 CAV.)
PART NO.	PACKAGING

PS-73436-009	ELECTRO/MECH. PERFORM.
SPECIFICATION	DESCRIPTION

ADDED -0072	DESCRIPTION
FC NO: URF2007-0406	2007/05/24
DRAWN: LYN	2007/05/24
CHKD: APPR: MHIANG	2007/05/25
B2	REV

QUALITY SYMBOLS	GENERAL TOLERANCES (UNLESS SPECIFIED)
$\nabla=0$	mm INCH
$\nabla=0$	4 PLACES ± --- ± ---
	3 PLACES ± --- ± ---
	2 PLACES ± --- ± ---
	1 PLACE ± --- ± ---
	ANGULAR ± 2 °
	DRAFT WHERE APPLICABLE MUST REMAIN WITHIN DIMENSIONS

DIMENSION STYLE	SCALE
MM/IN	DESIGN UNITS METRIC
DRAWN BY	DATE
LYNN	1998/10/19
CHECKED BY	DATE
XXX	0000/00/00
APPROVED BY	DATE
XXX	0000/00/00
MATERIAL NO.	DOCUMENT NO.
SEE TABLE	SD-73391-007

THIRD ANGLE PROJECTION	TITLE	SHEET NO.
C	SMA JACK VERTICAL PCB 50 OHMS SMA-J/PCB	1 OF 1
	MOLEX INCORPORATED	
	THIS DRAWING CONTAINS INFORMATION THAT IS PROPRIETARY TO MOLEX INCORPORATED AND SHOULD NOT BE USED WITHOUT WRITTEN PERMISSION	

12 11 10 9 8 7 6 5 4 3 2 1